

link

**UM
NOVO
JEITO
DE CRIAR**

**UNA
NUEVA
FORMA
DE CREAR**



MANUAL DE MONTAGEM

MANUAL DE INSTALACIÓN



ROMETAL

CONFIRA O VÍDEO DE MONTAGEM DO PRODUTO.

MIRA EL VIDEO DE INSTALACIÓN DEL PRODUCTO.



Faça a leitura do QR Code com seu celular e confira o vídeo com o passo a passo de montagem do Link.

Lee el Código QR con tu celular y mira el video con el paso a paso de la instalación de Link.

FACILITANDO A MONTAGEM DO LINK. VEJA AS FERRAMENTAS QUE VOCÊ VAI PRECISAR:

CON LINK, LA INSTALACIÓN ES MUCHO MÁS FÁCIL. ESTAS SON LAS HERRAMIENTAS QUE NECESITARÁS:



**Serra de Bancada
Meia-Esquadria para
Alumínio**

Sierra Ingleteadora
Ángulo 45° para
Aluminio



Esquadro
Escuadra

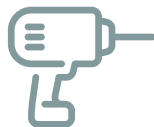

**Furadeira
Parafusadeira**
Taladro Atornillador



Trena
Cinta métrica



Escareador
Escariador



Broca 2,5mm
Broca 2,5mm



Ponteira
Puntera



Lápis
Lápiz



Álcool
Alcohol

NÃO DEIXE DE CONFERIR AS CONDIÇÕES ADEQUADAS DE MONTAGEM E USO

VERIFICA LAS CONDICIONES ADECUADAS DE INSTALACIÓN Y USO

Na Base En la base

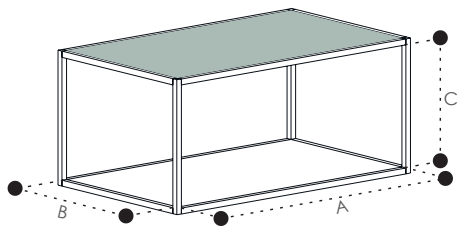

Tamanho máximo por travessa:
A=100cm B=60cm C=100cm
Tamaño máximo por columna:
A=100cm B=60cm B=100cm

Suspensão Suspendido

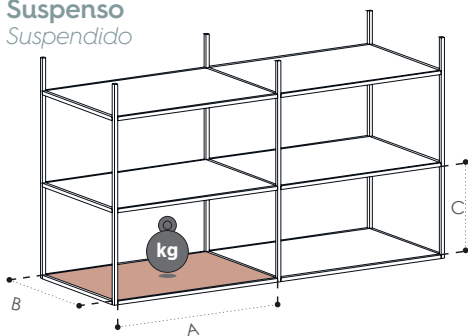

Peso máximo distribuído:
25kg/m²
Peso máximo distribuído:
25kg/m²

Parede Pared

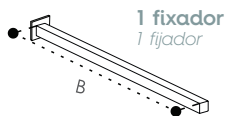
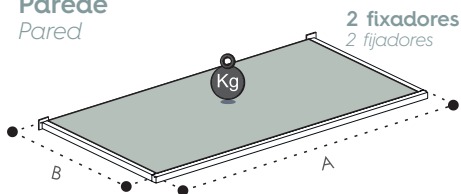

Tamanho máximo por travessa:
A=100cm B=40cm C=100cm
Tamaño máximo por columna:
A=100cm B=40cm B=100cm

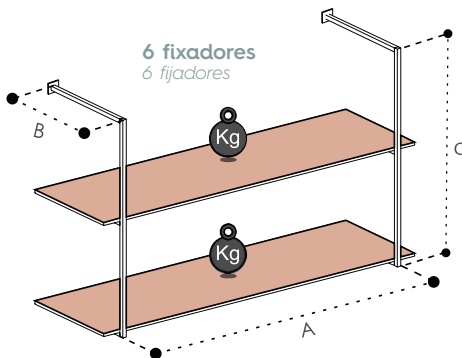

Número de fixadores teto/parede Número de fijadores techo/pared	Peso máximo distribuído Peso máximo distribuído
1	5kg
2	10kg
4	20kg
6	30kg

A mesma regra serve para os 3 modelos:
La misma regla sirve para los 3 modelos:



RM-283



RM-284



RM-311

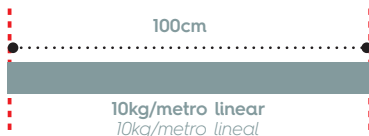

PERFIS

PERFILES

3 MODELOS

SEM ABA
SIN ALETA



RM-283

UMA ABA
UNA ALETA

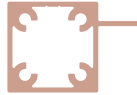

RM-284

DUAS ABAS
DOS ALETAS

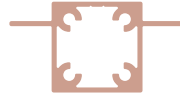

RM-311

COMPONENTES

COMPONENTES



Conector Reto
Riel Recto



Conector 45°
Riel 45°



Tampa de Acabamento
Tapa de Acabado

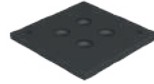

**Fixação Teto/
Parede**
*Fijación Techo/
Pared*

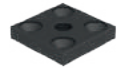

Fixação Rodízio/Sapata
*Fijación Rueda/
Pie Regulador*

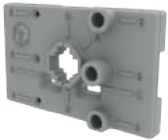

Gabarito
Plantilla



Broca Link
Broca Link



Rodízio Leve até 35kg
Rueda Liviana hasta 35kg



Sapata
Pie Regulador

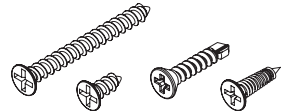

Parafusos
Tornillos

GABARITO PLANTILLA

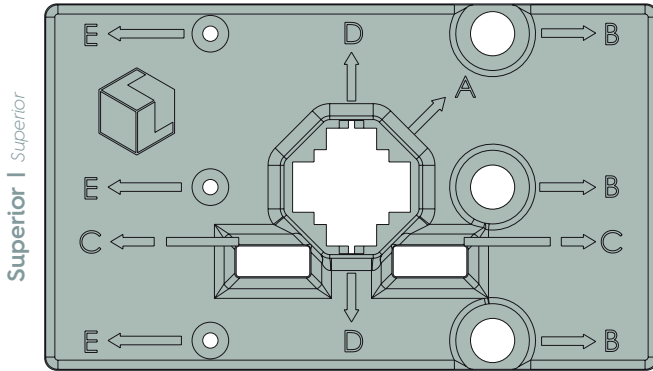

- A** - Posicionador do conector | Posicionador del riel
B - Guia de furação para broca escalonada | Guía de perforación para broca escalonada
C - Visor para auxiliar na posição do conector em perfis com ou sem tampa de acabamento | Visor para asistir en el posicionamiento del riel en perfiles con o sin tapa de acabado
D - Marcação para auxiliar na centralização do conector | Marca para asistir en la centralización del riel
E - Guia de furação sem escareado | Guía de perforación sin escariado

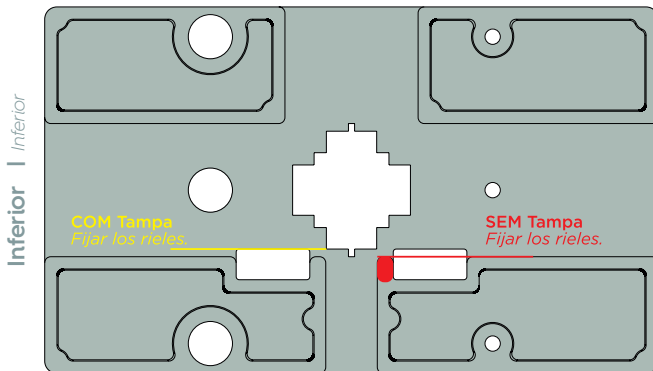

- Na parte inferior do gabarito, temos os encaixes do perfil para centralizar o conector perfeitamente nas montagens. | En la parte inferior de la plantilla, están las ranuras del perfil para centralizar el riel perfectamente en la instalación.
- Com Tampa (amarelo)** - Aba para fixação do conector quando for utilizar a tampa de acabamento. | Con Tapa (amarillo) - Aleta para fijar el riel cuando se utilice la tapa de acabado.
- Sem Tampa (vermelho)** - Encosto para fixação do conector quando não for utilizar tampa de acabamento. | Sin Tapa (rojo) - Apoyo para fijar el riel cuando no se utilice tapa de acabado.

BROCA PADRÃO DE MERCADO

BROCA ESTÁNDAR DE MERCADO

Primeiro processo: Furação com broca fina 2mm.

Primer proceso: Perforación con broca fina 2mm.

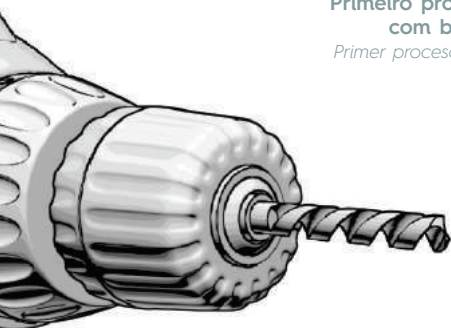

Segundo processo: Escarear com broca 7 ou 8mm no escareador.

Segundo proceso: Escariar con broca de 7 u 8mm.

Confira abaixo a sequência de colocação da broca e furação com gabarito.
Mira cómo colocar la broca y realizar la perforación con la plantilla.

PASSO A PASSO:

PASO A PASO:

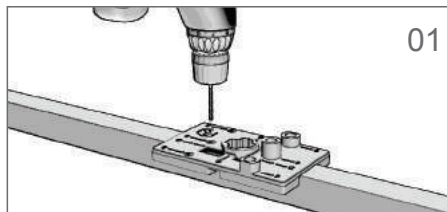

01

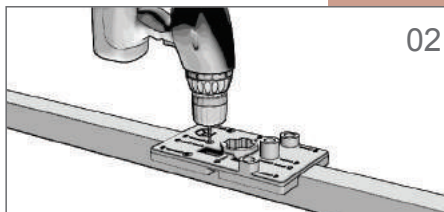

02

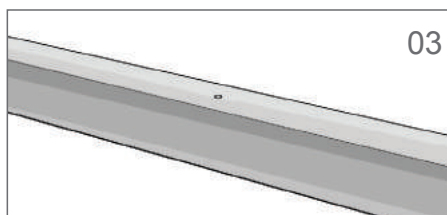

03

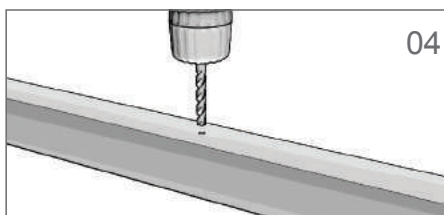

04

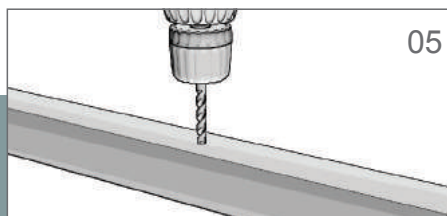

05

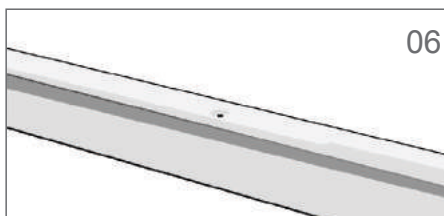

06

GABARITO (FIXAÇÃO DO CONECTOR)

PLANTILLA (FIJACIÓN DEL RIEL)

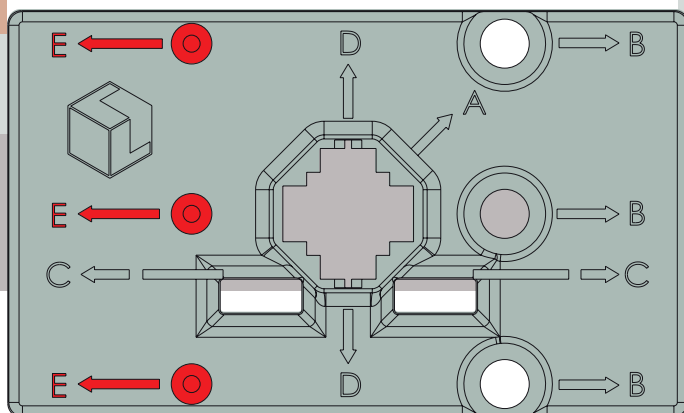

Perfil | Perfil

As marcações com a letra E indicam o local para furação com a broca tradicional.
Las marcas con la letra E indican el lugar para perforación con la broca tradicional.

PASSO A PASSO:

PASO A PASO:

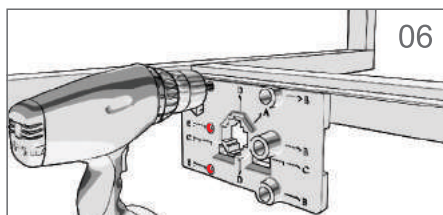
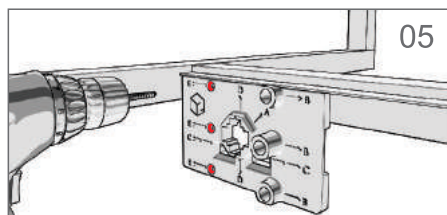
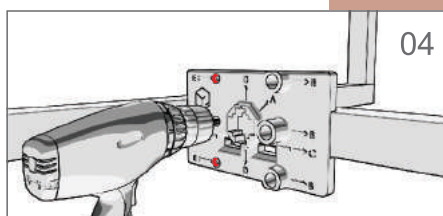
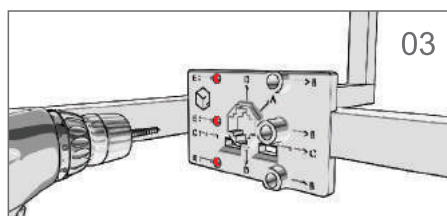
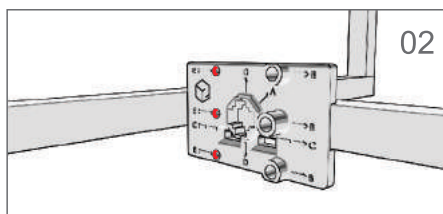
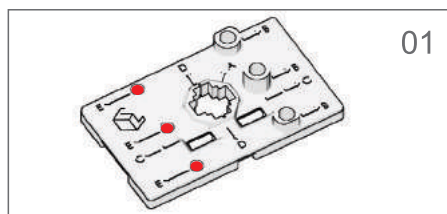

BROCA LINK

BROCA LINK

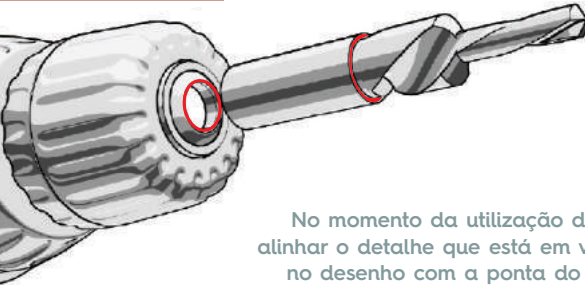

Sempre utilizar álcool junto à furação para facilitar a mesma.
Siempre utilizar alcohol en la perforación para facilitar el proceso.

No momento da utilização da broca, alinhar o detalhe que está em vermelho no desenho com a ponta do mandril.

Al momento de utilizar la broca, alinear el detalle que está en rojo en el diseño con la punta del mandril.

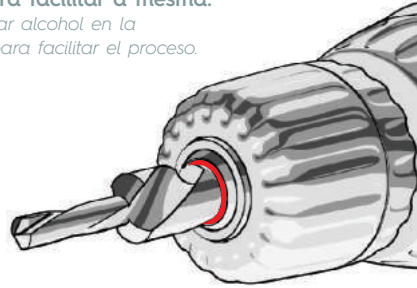

Confira abaixo a sequência de colocação da broca e furação com o gabarito.
Mira cómo colocar la broca y realizar la perforación con la plantilla.

PASSO A PASSO:

PASO A PASO:

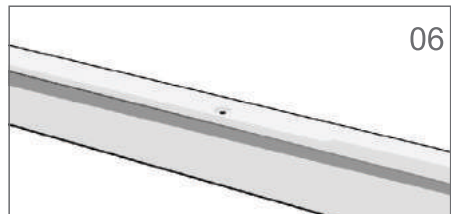
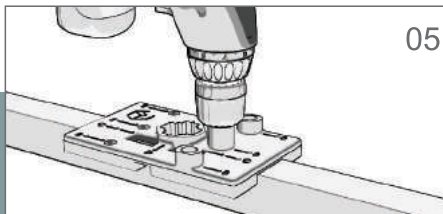
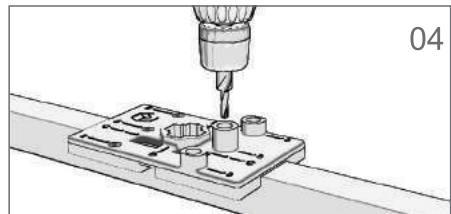
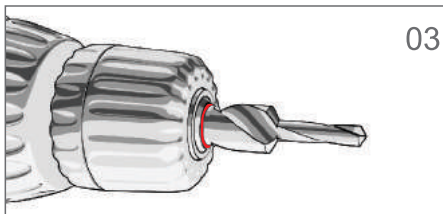
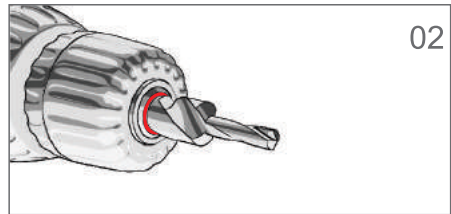
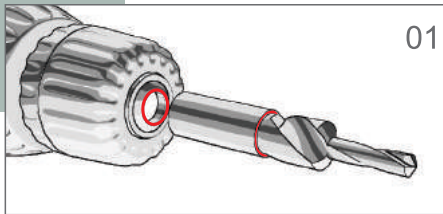

GABARITO (FURAÇÃO COM BROCA LINK)

PLANTILLA (PERFORACIÓN CON BROCA LINK)

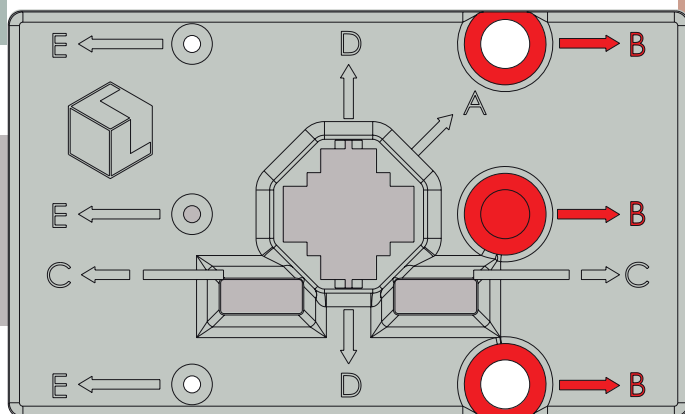

Perfil | Perfil

As marcações com a letra B indicam o local para furação com a broca escariada.
Las marcas con la letra B indican el lugar para realizar la perforación con la broca escariadora.

PASSO A PASSO:

PASO A PASO:

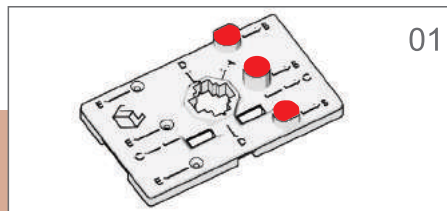

01

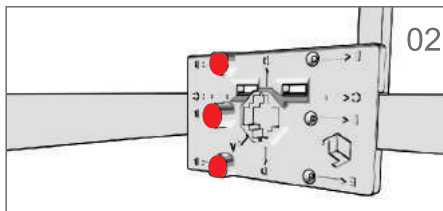

02

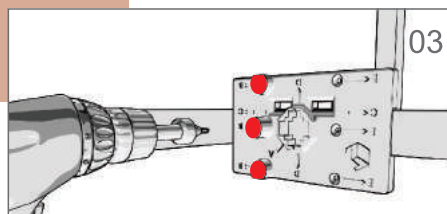

03

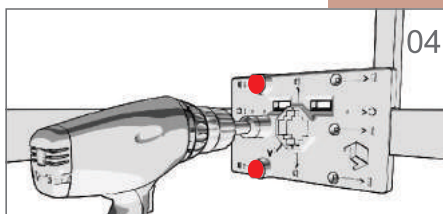

04

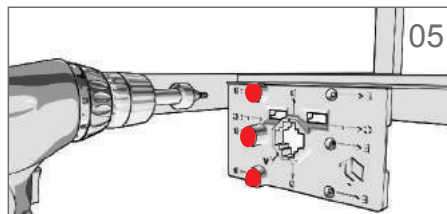

05

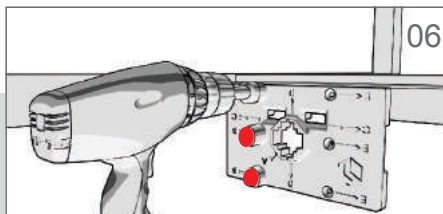

06

GABARITO (FIXAÇÃO DO CONECTOR)

PLANTILLA (FIJACIÓN DEL RIEL)

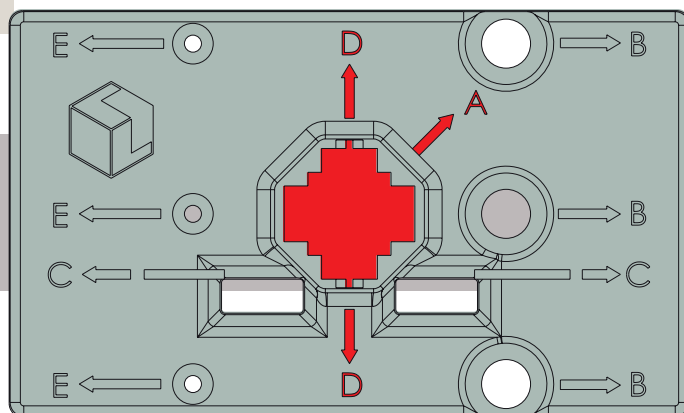

Perfil | Perfil

A letra A representa o encaixe do conector, e a letra D, o alinhamento no perfil.

La letra A representa la ranura del riel, y la letra D, la alineación en el perfil.

PASSO A PASSO:

PASO A PASO:

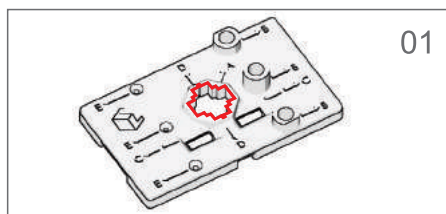

01

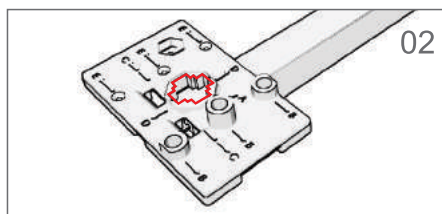

02

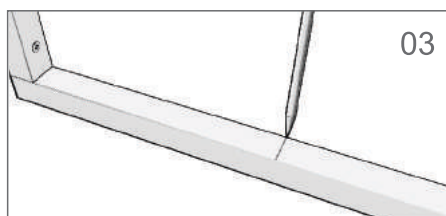

03

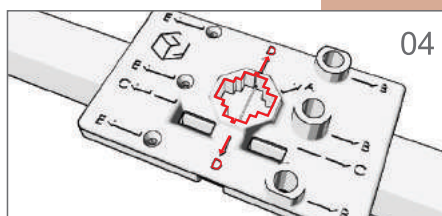

04

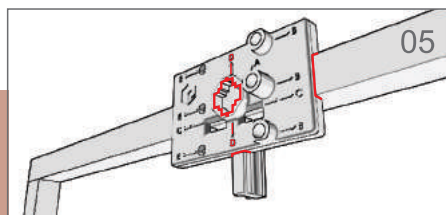

05

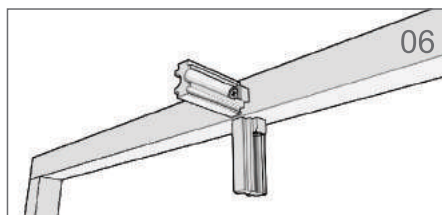

06

FIXAÇÃO 45°

FIJACIÓN 45°

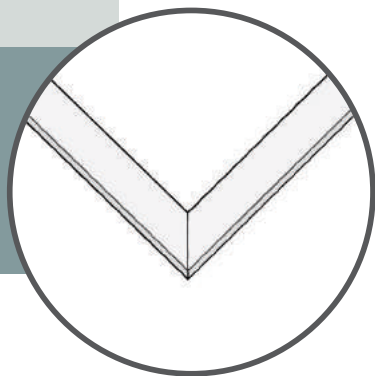

Corte o Link em 45°, utilize o conector indicado e o gabarito.
Corta el Link a 45° y utiliza el riel indicado y la plantilla.

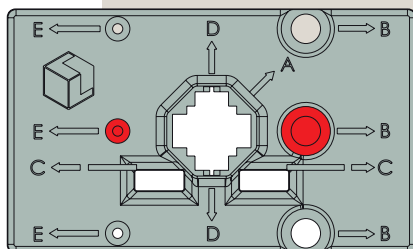

Conector 45°
Riel 45°

Perfil | Perfil

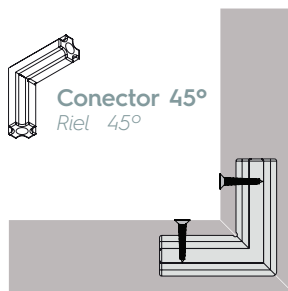

PASSO A PASSO:

PASO A PASO:

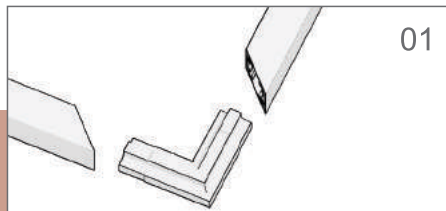

01

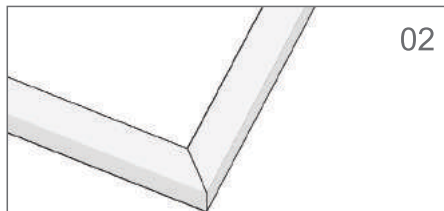

02

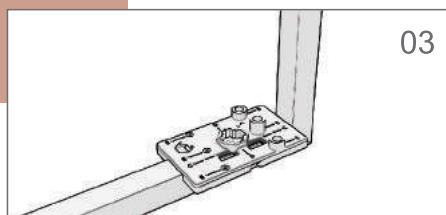

03

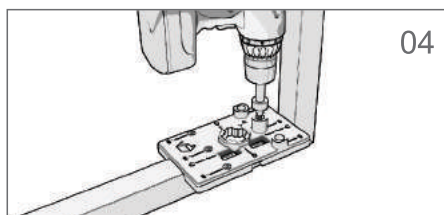

04

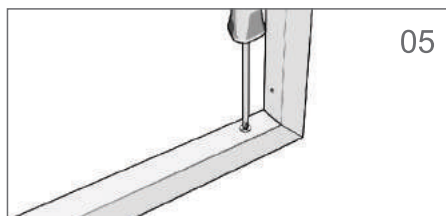

05

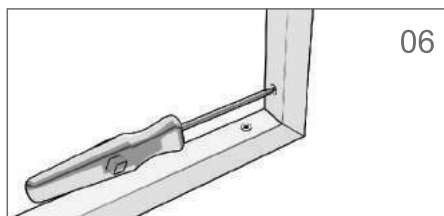

06

FIXAÇÃO DE CANTONEIRA CORTE 45°

FIJACIÓN ESQUINERO CORTE 45°

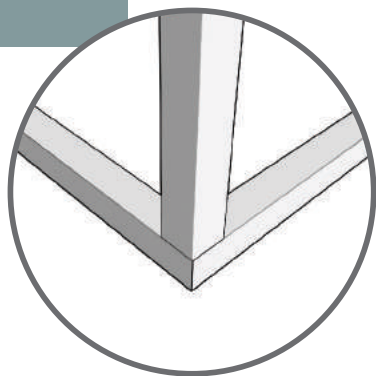

Fixe a cantoneira utilizando o conector reto e gabarito.

Fija el esquinero utilizando el riel recto y la plantilla.

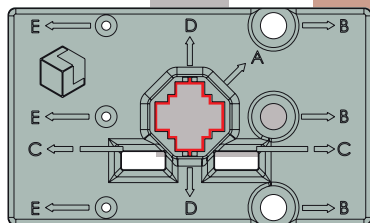

Perfil
Perfil

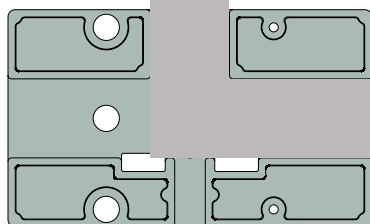

Perfil
Perfil

PASSO A PASSO:

PASO A PASO:

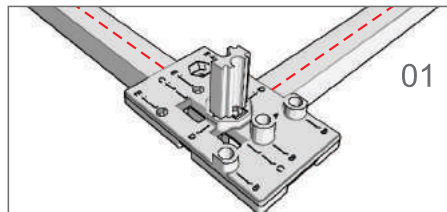

01

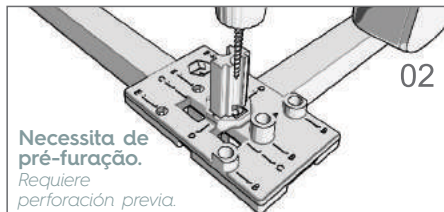

02

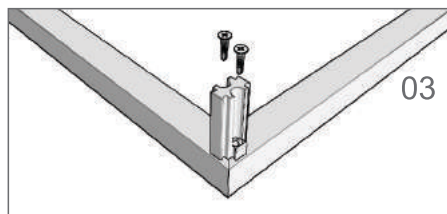

03

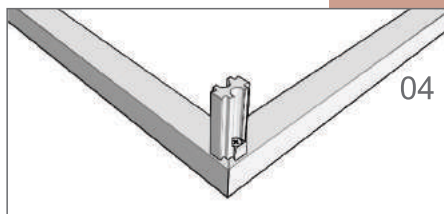

04

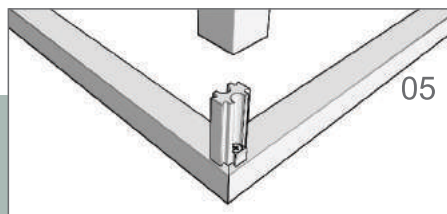

05

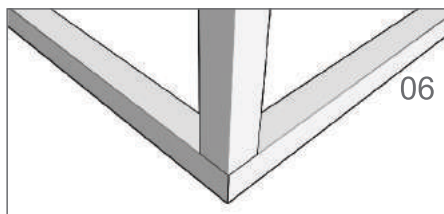

06

FIXAÇÃO CORTE RETO SEM TAMPA

FIJACIÓN CORTE RECTO SIN TAPA

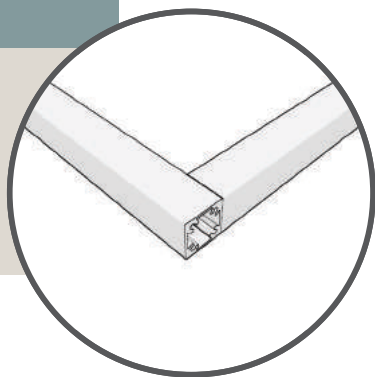

Para fixação sem tampa,
alinhe o perfil Link no
encaixe do gabarito.

Para fijación sin tapa,
aline el Link en la ranura de la plantilla.

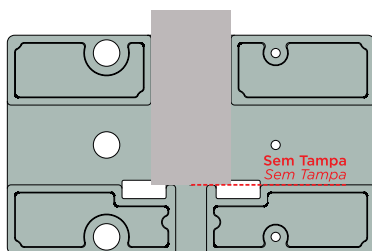
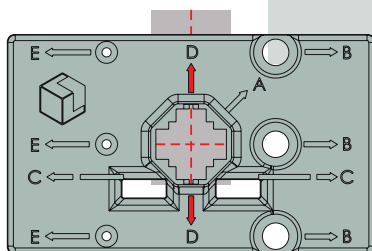

PASSO A PASSO:

PASO A PASO:

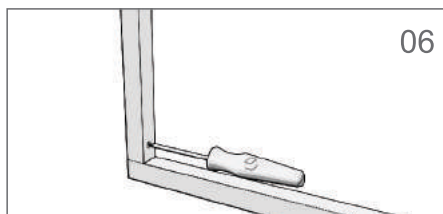
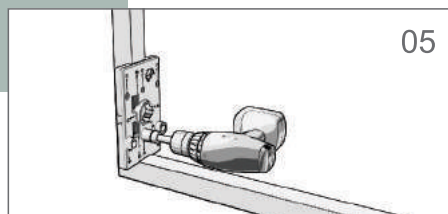
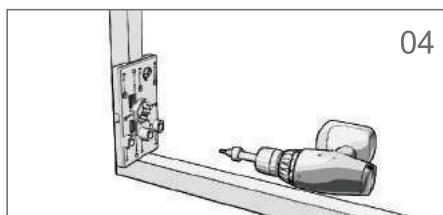
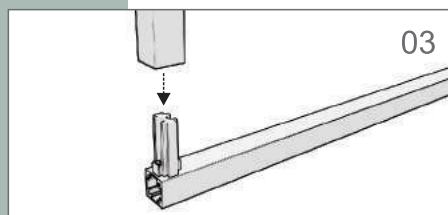
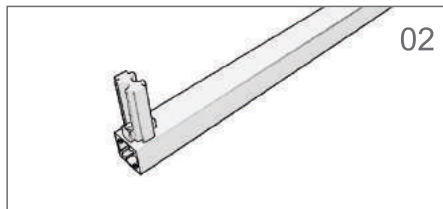
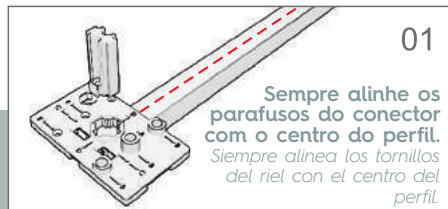

FIXAÇÃO CORTE RETO COM TAMPA

FIJACIÓN CORTE RECTO CON TAPA

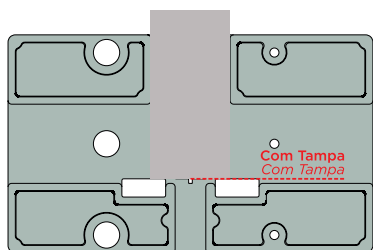
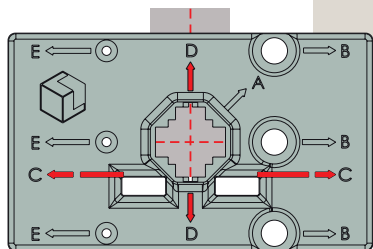
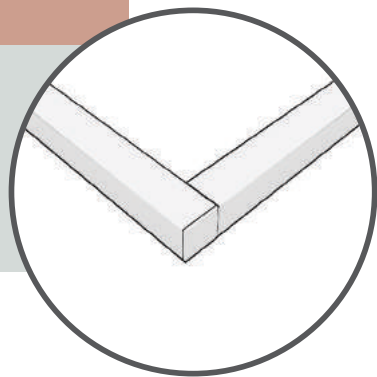

Para fixação com tampa,
alinhe o Link pela letra C.
Para fijación con tapa, alinea
el Link por la letra C

PASSO A PASSO:

PASSO A PASSO:

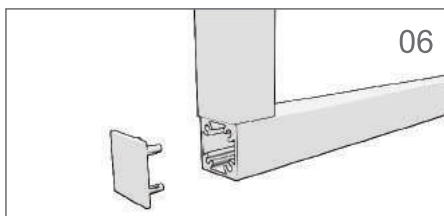
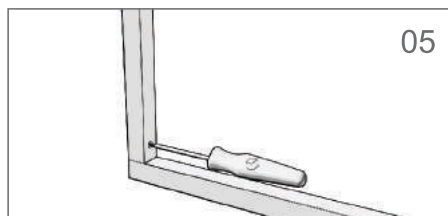
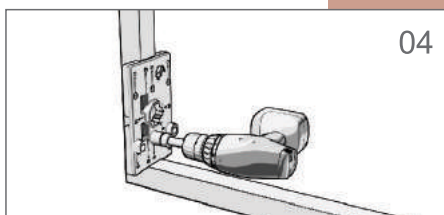
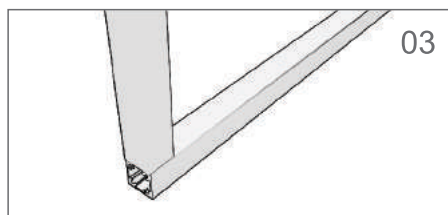
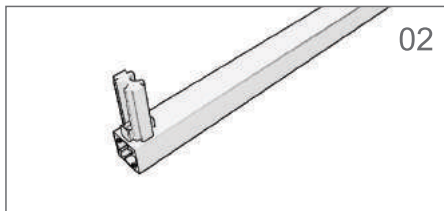
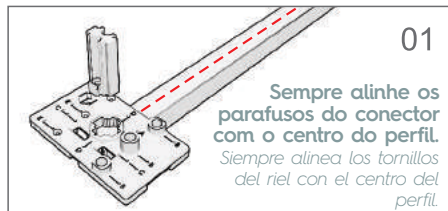

FIXAÇÃO DE CANTONEIRA COM CORTE RETO

FIJACIÓN ESQUINERO CORTE RECTO

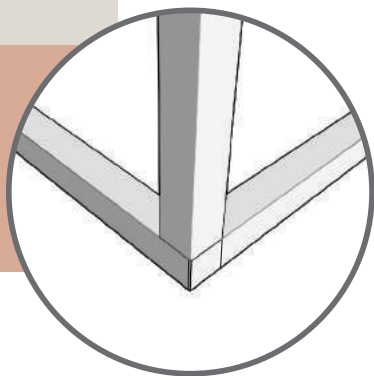

Fixe a cantoneira utilizando o conector reto e o gabarito.

Fija el esquinero utilizando el riel recto y la plantilla.

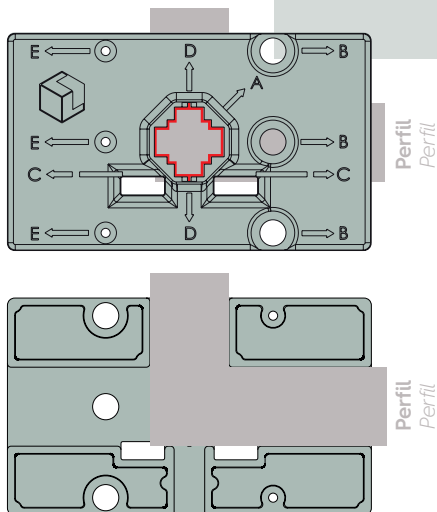

PASSO A PASSO:

PASO A PASO:

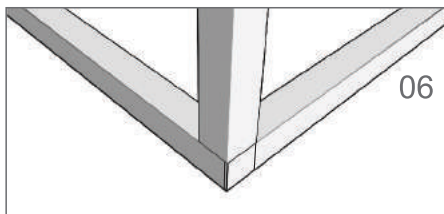
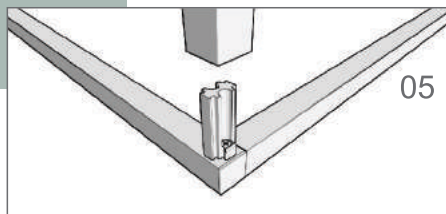
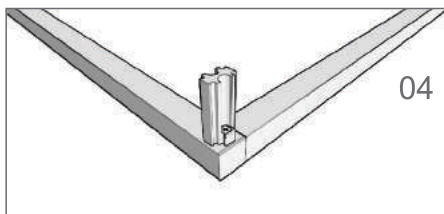
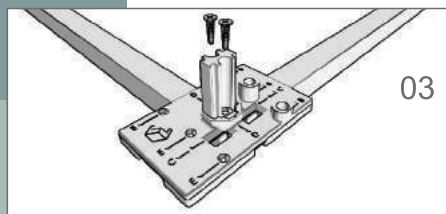
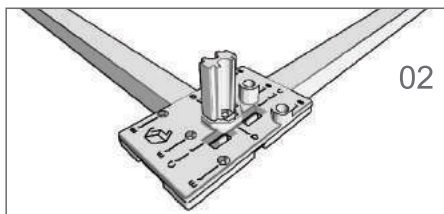
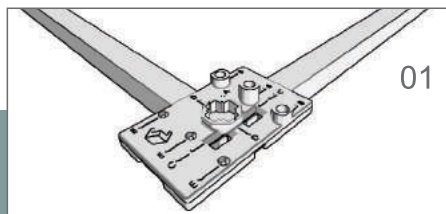

MONTAGEM DE TRAVESSAS

INSTALACIÓN COLUMNAS

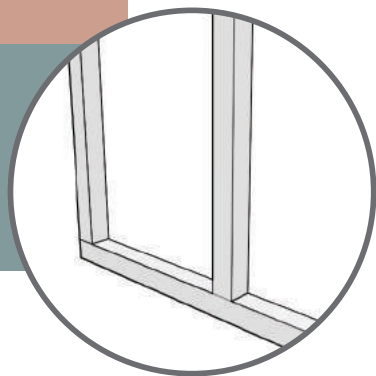

Fixe as travessas utilizando o conector reto e o gabarito.

Fija las columnas utilizando el recto y la plantilla.

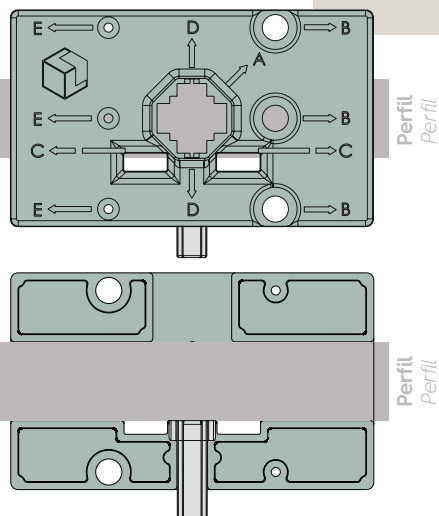

PASSO A PASSO:

PASO A PASO:



01

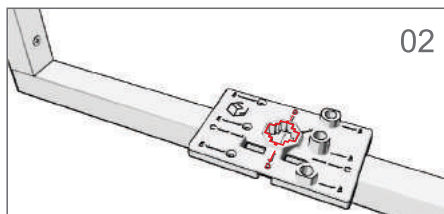

02

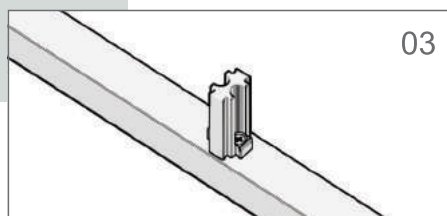

03

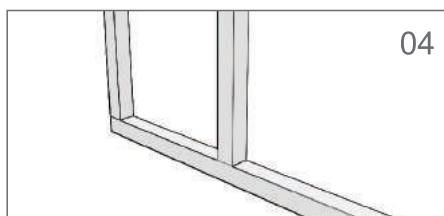

04

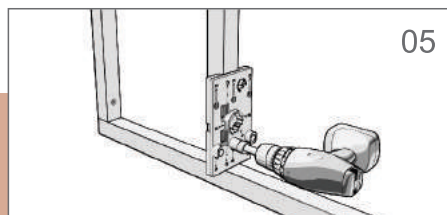

05

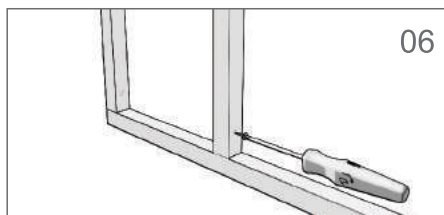

06

MONTAGEM DE FIXAÇÃO APARENTE

INSTALACIÓN FIJACIÓN A LA VISTA

Teto
Techo

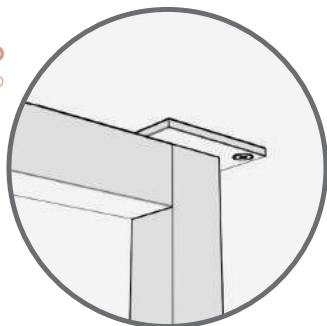

Parede
Pared

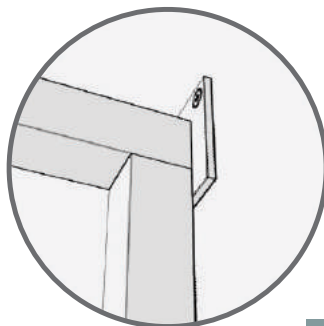

PASSO A PASSO:

PASO A PASO:

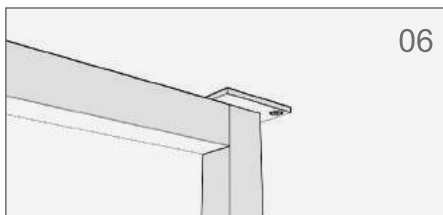
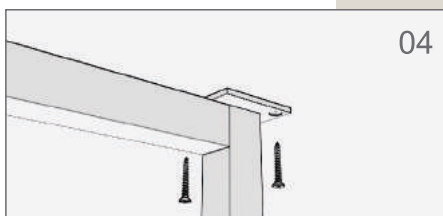
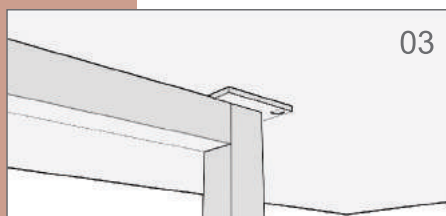
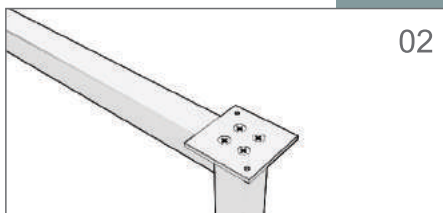
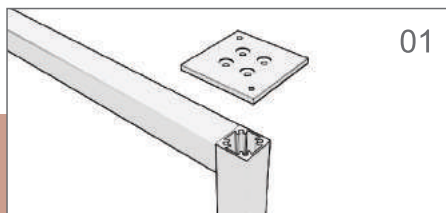

MONTAGEM DE SUSTENTAÇÃO

INSTALACIÓN SOPORTE

Pé regulador
Pie regulador

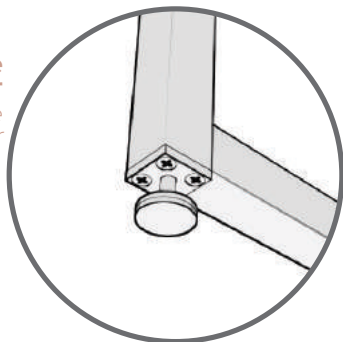

Rodízio
Rueda

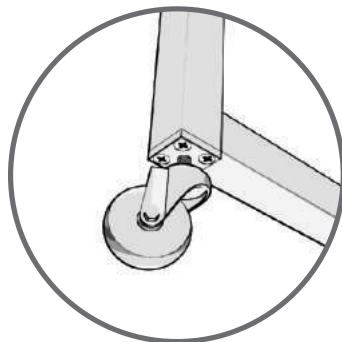

PASSO A PASSO:

PASO A PASO:

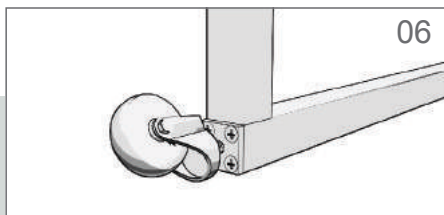
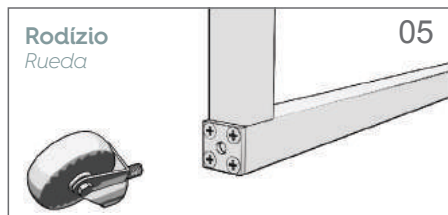
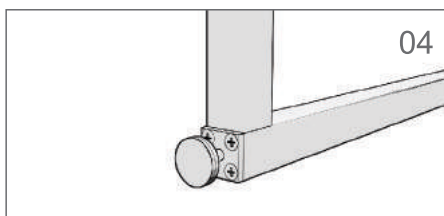
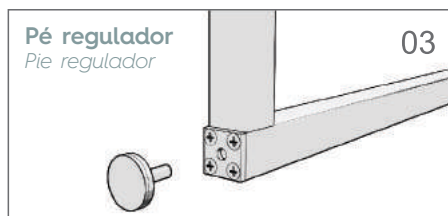
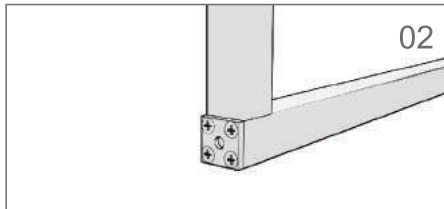
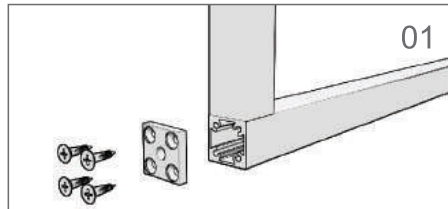

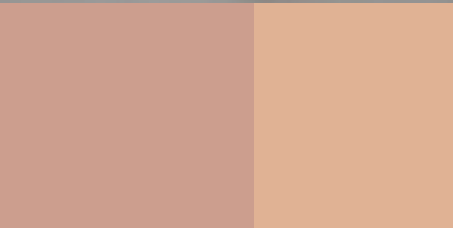
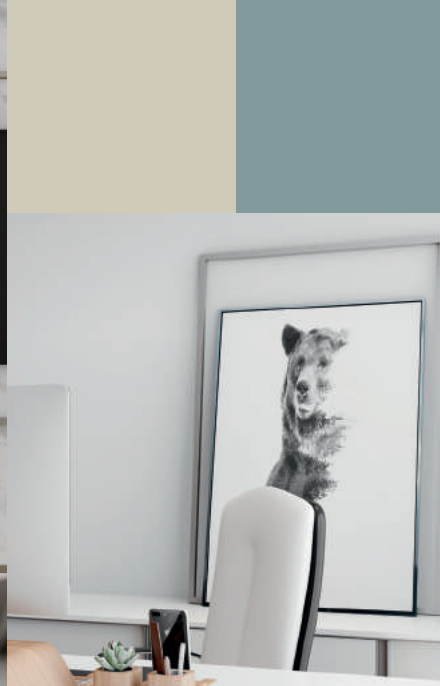

K

N



L

I

K



ROMETAL

Unidade Soluções & Alumínio
Unidad Soluciones & Aluminio
Rodovia BR 470 | km 174, 5 | nº 4075
Bairro Universal | CEP 95330-000
Veranópolis | RS | Brasil
Fone/Teléfono: +55 54 3441.3100
www.rometal.com.br



ROMETAL